

Commander Essentials Cordless W56P



Quick Installation Guide

Please read carefully before use.

COMMANDER

Packaging Contents

The following items are included in your W56P package:



W56H Handset



Base for
W52P/W56P

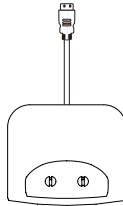

USB Charger
Cradle

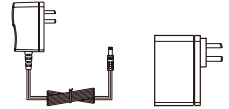

Two Power
Adapters

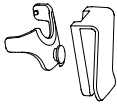

Belt Clip

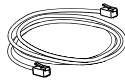

Ethernet Cable



Rechargeable
Battery

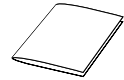

Quick Reference
Guide and Quick
Installation Guide

Note: Commander Essentials Cordless W56P IP DECT phone consists of one Base for W52P/W56P and one W56H Handset.

Assembling the Base Station & DECT Phone

1. Connect the network and power for the base station in one of the following ways, as shown below:

a. AC Power Option

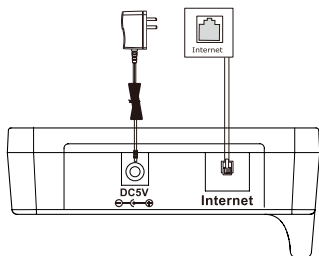

b. PoE (Power over Ethernet) Option

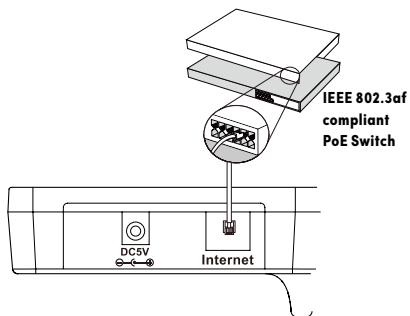

Note: If inline power (PoE) is provided, you do not need to connect the power adapter. Make sure the switch is PoE-compliant. If using the power adapter, the base station should be used with an original power adapter only. The use of a third-party power adapter may cause the damage to the base station.

2. Insert the battery into the handset, as shown below:

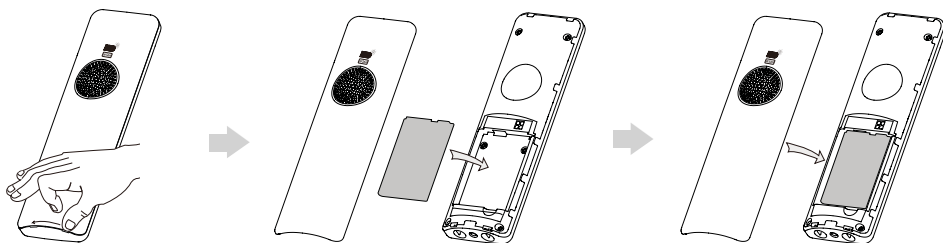

Note: The handset in this package is already registered to the base station. Should you have any requirement to re-register the W56H handset with the base, please see the W56H Quick Installation Guide from the resource centre.

3. Connect the charger cradle and charge the handset, as shown below:

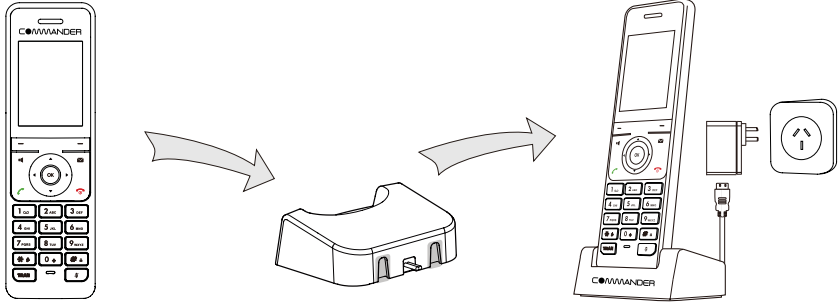

Note: The handset should be used with an original power adapter only. The use of a third-party power adapter may cause the damage to the handset. The charging status of the handset is indicated in the top right-hand corner of the LCD screen.

5. Attach the Belt Clip, as shown below if required:

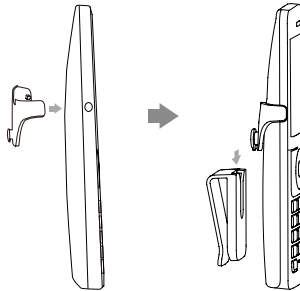

After the IP phone is connected to the network and supplied with power, it automatically begins with the initialisation process.

Please allow up to 10–15 minutes for the phone to connect to Commander's servers to collect their configuration and any required updates to both the base station and handset/s. The phone may reboot two or three times during this process or after factory default setting is made. Do **NOT** interrupt this process. The display may indicate the current status of the operation with '**initialising**' and '**configuration updating**'. After startup, the phone is ready for use.

If you require assistance, please call the Commander Phone team on 1300 638 208, or email us at commanderphone@commander.com.

COMMANDER

Level 10, 452 Flinders St Melbourne VIC 3000

ABN 85 136 950 082